

Sound Kick 2

Hi,
Let's get started.

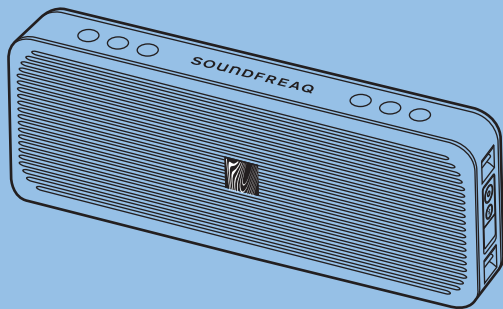

SOUNDFREQ®

SOUNDFREQ[®]

Welcome,

We are a co-op of craftsmen— designers and engineers—with a passion for great sound. We develop our products from the ground up to offer premium sound quality and wireless versatility.

Thank you for choosing Sound Kick 2. We sincerely hope that you enjoy your new wireless speaker system. Please share your experience with us:

connect@soundfreaq.com

Happy listening to you.



facebook.com/soundfreaq



twitter.com/soundfreaq



pinterest.com/soundfreaq



instagram.com/soundfreaq

You're invited to join the
Soundfreak community

Getting to Know Sound Kick 2

TOP

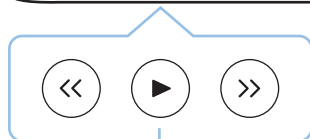

Play Controls

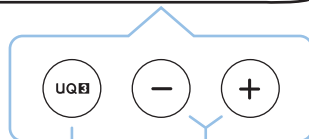

UQ3 Button

Volume

Getting to Know Sound Kick 2

SIDES

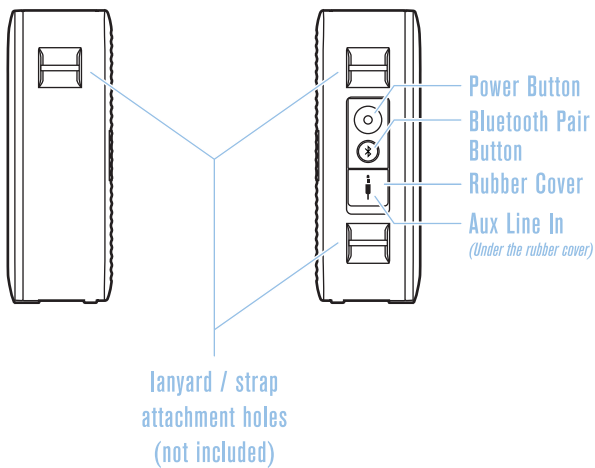

Getting to Know Sound Kick 2

BACK

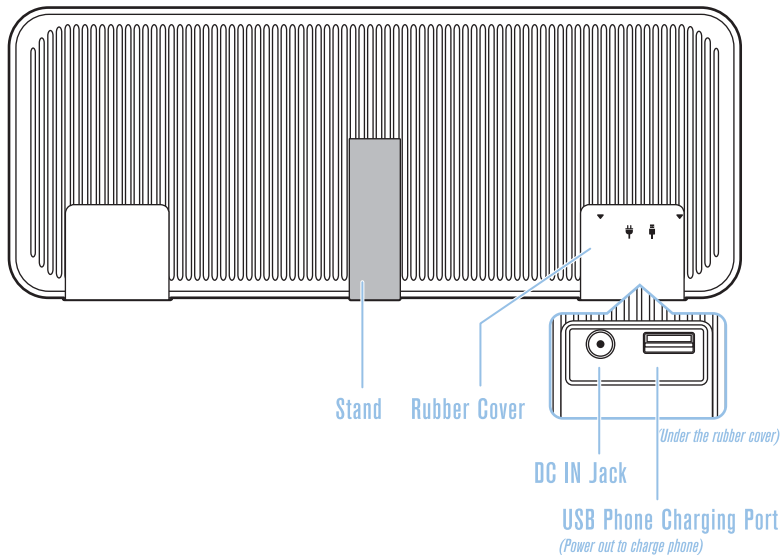

Placing Sound Kick 2

You can place the Sound Kick 2 directly onto a flat surface (such as a desk, a table, etc.) or stand the system up on a desk or table using the stand on the back.

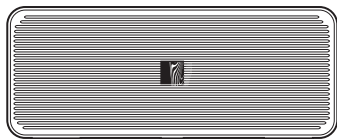

or

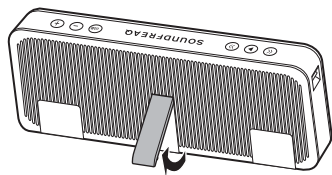

When the system is used outdoor and in the rain, please ensure the two rubber covers are closed securely, and the water won't flow into system.

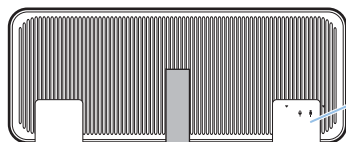

Rubber Covers



Turning on Sound Kick 2

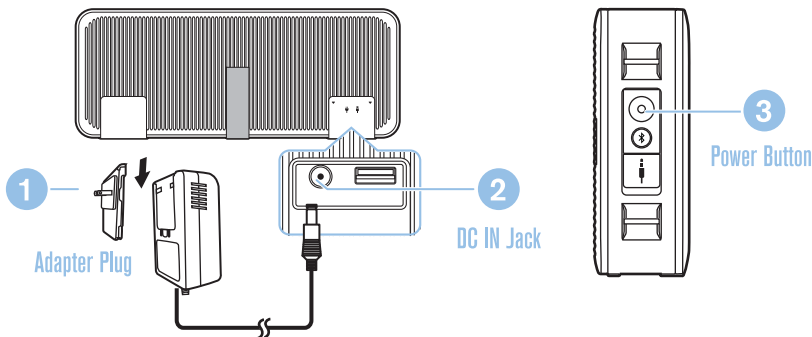

- 1 Insert the adapter plug into the AC power adapter if not already inserted.
- 2 Plug in the power supply and connect to the DC IN jack on Sound Kick 2.
- 3 Press **Power Button** to turn on.

Charging Sound Kick 2

Sound Kick 2 has a built in rechargeable battery to power without using the power supply. When the adapter is plugged in, the battery will charge.

The charging indicator combined to **Power Button** indicates the charging status:

| Mode | Charging | Fully Charged |
|-------------------------------------|------------------------------------|---------------------------|
| Standby | <i>Blinking Green (Slowly)</i> | <i>Off (No light)</i> |
| Power on (not connected) | <i>Blinks Green</i> | <i>Blinks White</i> |
| Bluetooth or Aux in mode | <i>Solid Green</i> | <i>Solid White</i> |

- * *When operating the unit in battery mode, alternately flashing white and green means the battery power is low.*
- * *When not in use for 45 minutes, Sound Kick 2 will turn off to save power. To deactivate Power saving mode, hold the pair and play buttons down until indicator light flashes twice. When indicator light flashes once, Power saving mode is activated. Bluetooth and Aux line in must be disconnected in order for power saving mode to be activated.*

Bluetooth Pairing

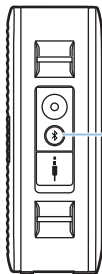

1

Bluetooth Pair Button

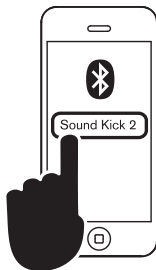

2

Bluetooth Pairing

- 1 Press **Bluetooth Pair Button** (⌘) on Sound Kick 2 to start pair mode. The **Power Button** light will flash rapidly.
 - 2 On your phone, tablet or computer, enter your Bluetooth settings menu to detect available devices. Once Sound Kick 2 is detected, select it from the list of available devices to connect.
- * On iPod, iPhone and iPad devices tap to select "Sound Kick 2" from the list of devices in Bluetooth settings.

Bluetooth Pairing

- * Please visit “support.soundfreaq.com” for detailed pairing instructions for Mac or Windows PC.
- * To pair another device, first disconnect the currently connected device by pressing and holding the pair button down. Once disconnected, the indicator light will flash rapidly. Simply repeat the pairing process with step 2 from the previous page. To re-connect a device that has already been paired, press **Bluetooth Pair Button** (✳) on Sound Kick 2 and select “Sound Kick 2” from your Bluetooth settings menu on your phone, tablet or computer.
- * On most devices, no password is needed to pair, however, if a password is requested the default password is “1234”.

You can change the volume by either using the volume buttons on Sound Kick 2 or changing the volume on your paired device. For max volume, turn both volumes to maximum.

Listening via Bluetooth

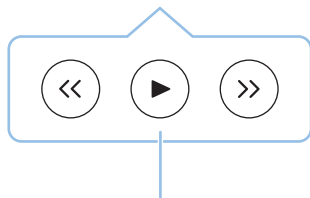

Play Controls

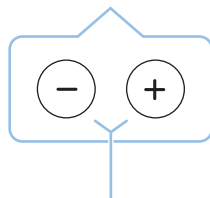

Volume

- * You can use the **Play Control Buttons** on Sound Kick 2 to remotely control your connected devices and play, pause and skip tracks.

Listening via Line In

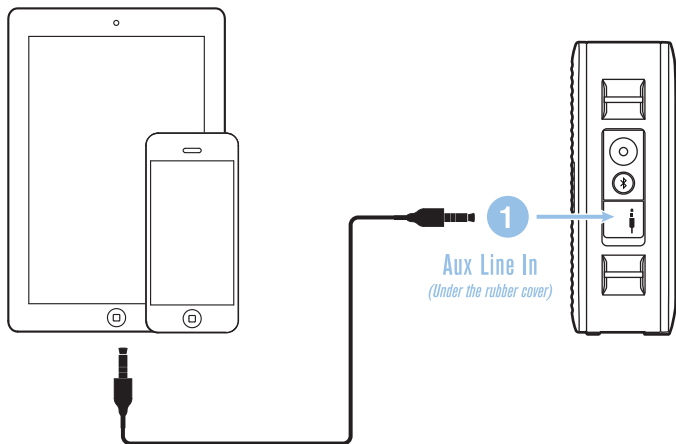

Listening via Line In

1 Connect any device with a standard headphone jack with a line in cable (not included). When a line in cable is plugged into Aux Line In, Sound Kick 2 will automatically change to Line In source mode. To change to Bluetooth mode, disconnect the line in cable.

* *In order to save the energy, please unplug the line in cable from the Aux Line In of Sound Kick 2 when not in use.*

Charging Devices with USB Power Port

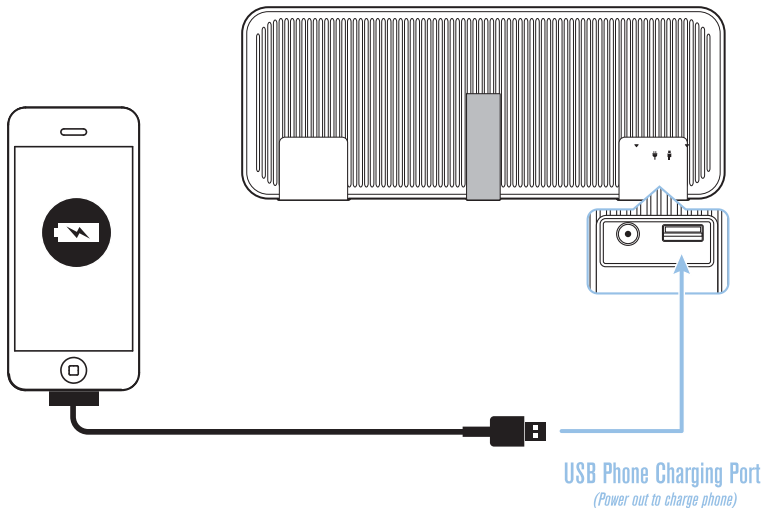

Charging Devices with USB Power Port

You can charge most phones as well as other USB chargeable devices such as Bluetooth headsets and digital cameras directly from Sound Kick 2.

When Sound Kick 2 is using the power supply, simply connect your device to the USB Port on the back of Sound Kick 2 to begin charging.

When Sound Kick 2 is using the battery power, turn on the Sound Kick 2 and connect your device to the USB Port on the back of Sound Kick 2 to begin charging.

- * *Sound Kick 2 can charge your phone both when Sound Kick 2 is being charged or running on battery power. The maximum charging output current is 1A. Please use the charging cable that was provided with your USB chargeable device.*

Optimizing Sound Quality

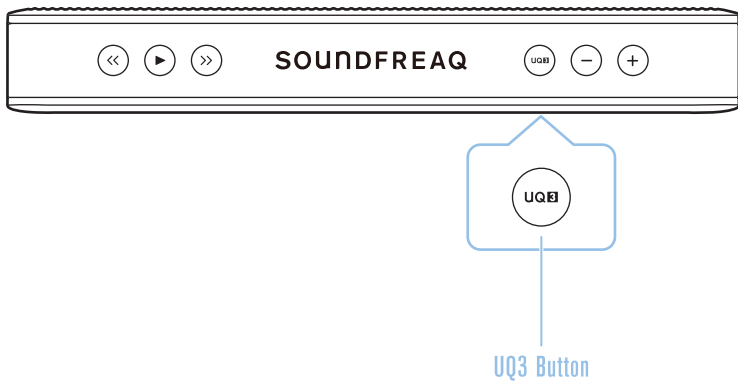

- * *When the light flashes once, UQ3 is on. When it flashes twice, UQ3 is off.*

Optimizing Sound Quality

UQ3™ is proprietary technology that enhances stereo separation. To turn UQ3 on/off, press the **UQ3** button. When the light flashes once, UQ3 is on and when it flashes twice, UQ3 is off. UQ3 is on by default.

TIP: Sound Kick 2 has been tuned to a balanced acoustic profile. You can use the EQ settings on your playback device to further customize the EQ balance to suit your personal preference. **Note:** Some custom EQ settings when combined with UQ3 enhancement may cause distortion.

TIP: For playback in Bluetooth or Aux mode, the output volume is set by both the volume control on Sound Kick 2 and the source device. Both may be adjusted to set your preferred listening volume. Typically, sound quality is best when the volume of the source device is between 70~90%.

Note: As with any speaker system, if the volume on both your source device and the speaker are at maximum output, it is possible to overdrive the speakers and cause distortion. When using an iOS device or other device that offers a “volume limit” feature, turn this setting off for higher volume listening in Bluetooth or Aux mode.

Note: Positioning Sound Kick 2 upright or back against its kickstand will change the direction sound is emitted, so try both options to determine the best position for your listening scenario.

For additional support, please visit us at
support.soundfreaq.com

Learn more about our complete line of
award-winning wireless speakers



soundfreaq.com

SOUNDFREQ[®]

soundfreq.com